

# 2025 SIDEWALK REPAIRS

PROJECT NUMBER: PW-2025-02  
DECEMBER 16, 2024

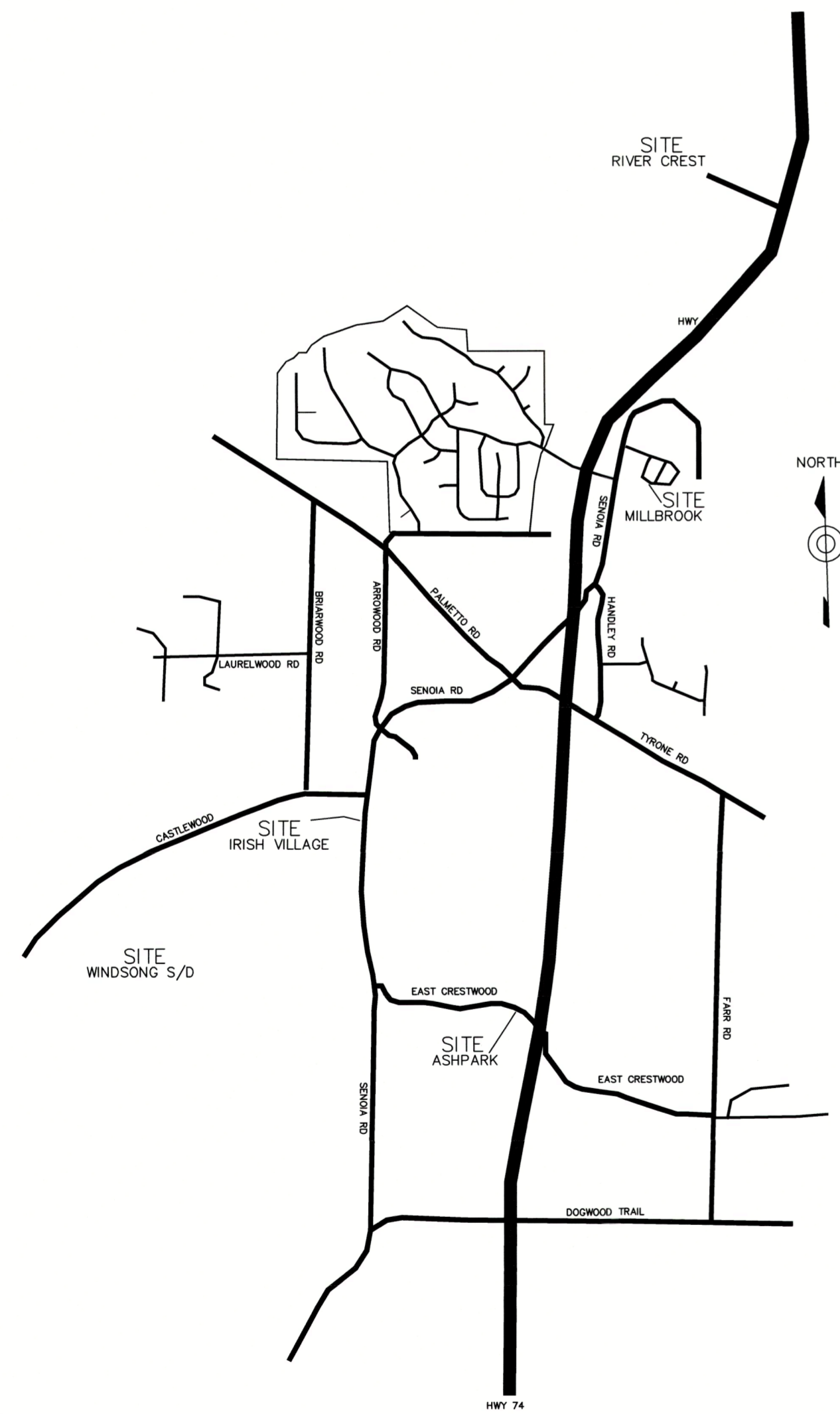

VICINITY MAP

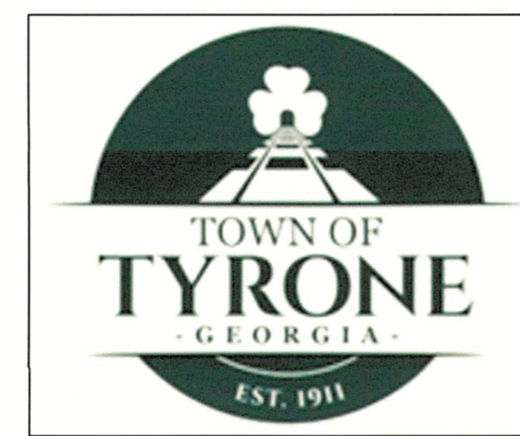

## TOWN OF TYRONE

950 SENOIA ROAD  
TYRONE, GA 30290  
770-487-4038

### DRAWING INDEX

TITLE SHEET

- C101 SIDEWALK PLANS & SCHEDULE
- C102 SIDEWALK DETAILS & SCHEDULE

BEFORE DIGGING IN  
 GEORGIA  
 CALL 811

TOWN OF TYRONE  
 950 SENOIA ROAD  
 TYRONE, GA 30290  
 770-487-4038

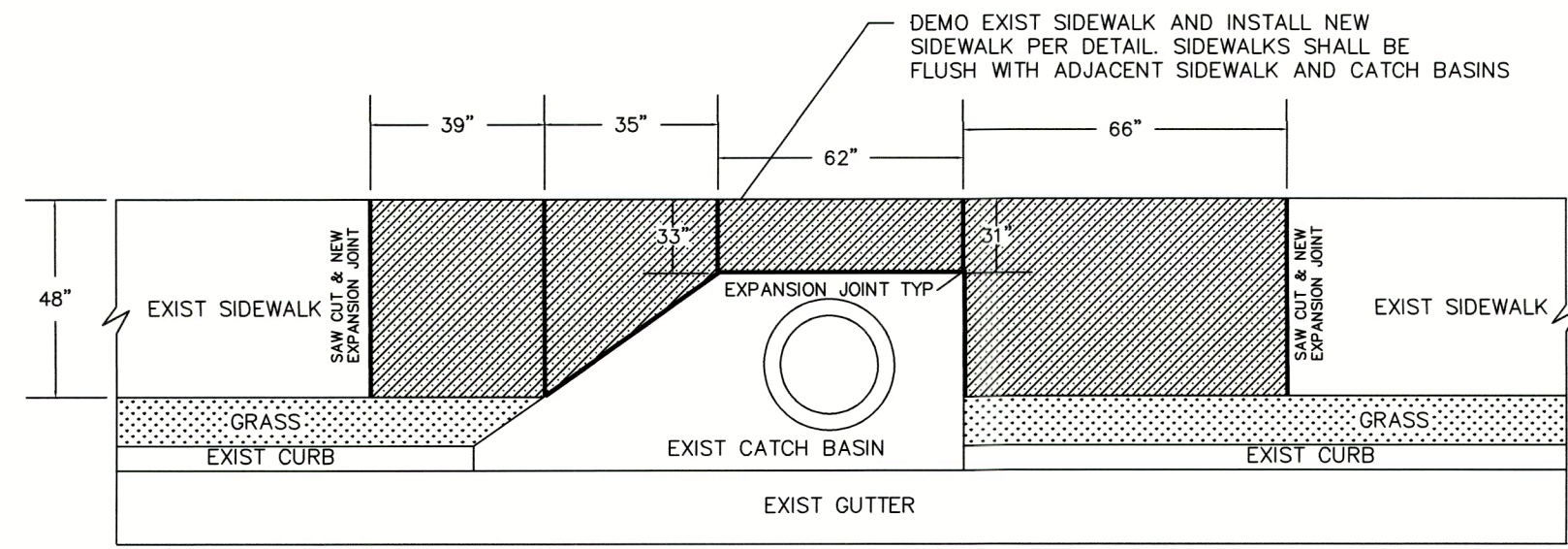
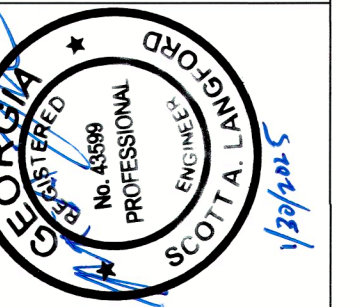

SIDEWALK REPAIR 310 MILLBROOK VILLAGE DRIVE  
 NTS

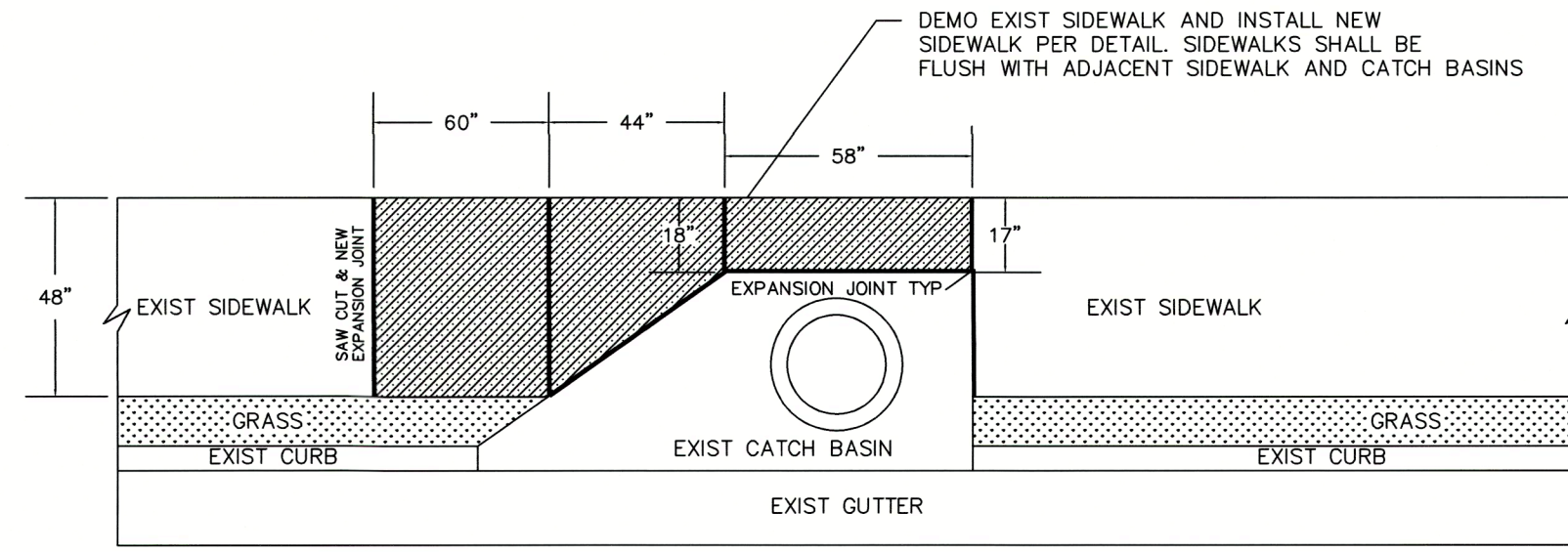

SIDEWALK REPAIR 360 MILLBROOK VILLAGE DRIVE  
 NTS

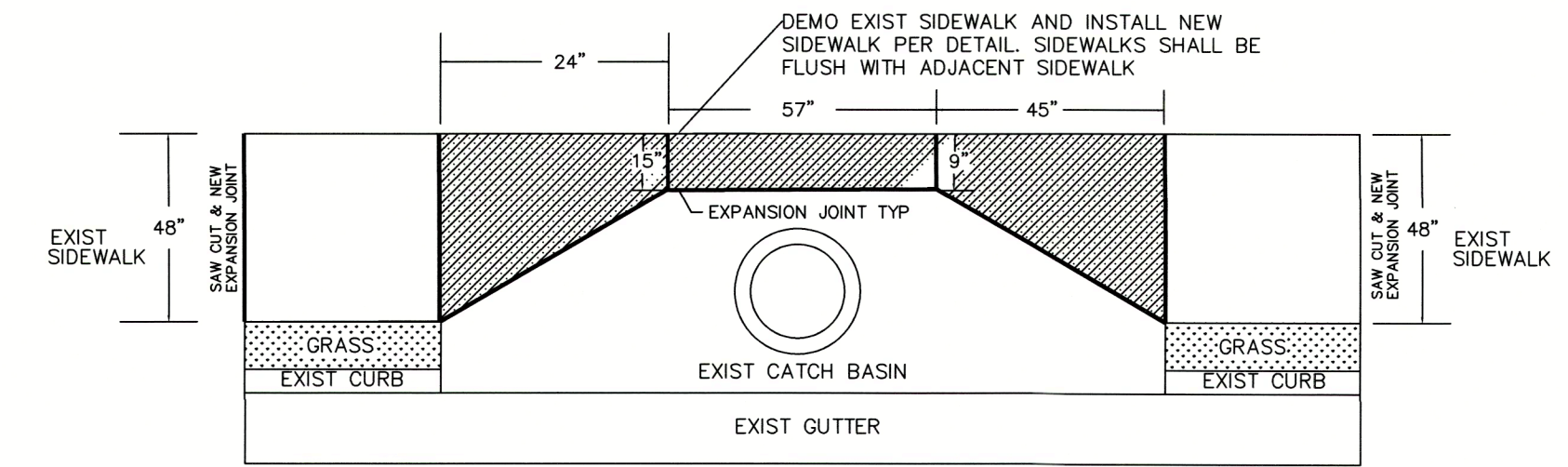

SIDEWALK REPAIR 160 IRISH LANE  
 NTS

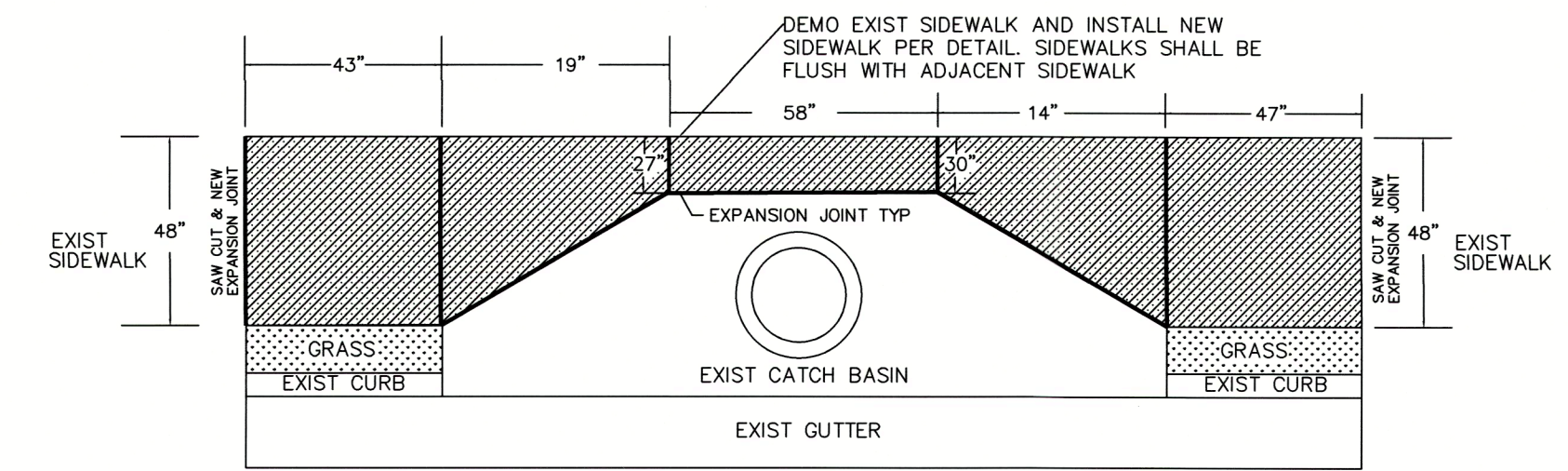

SIDEWALK REPAIR 125 IRISH LANE  
 NTS

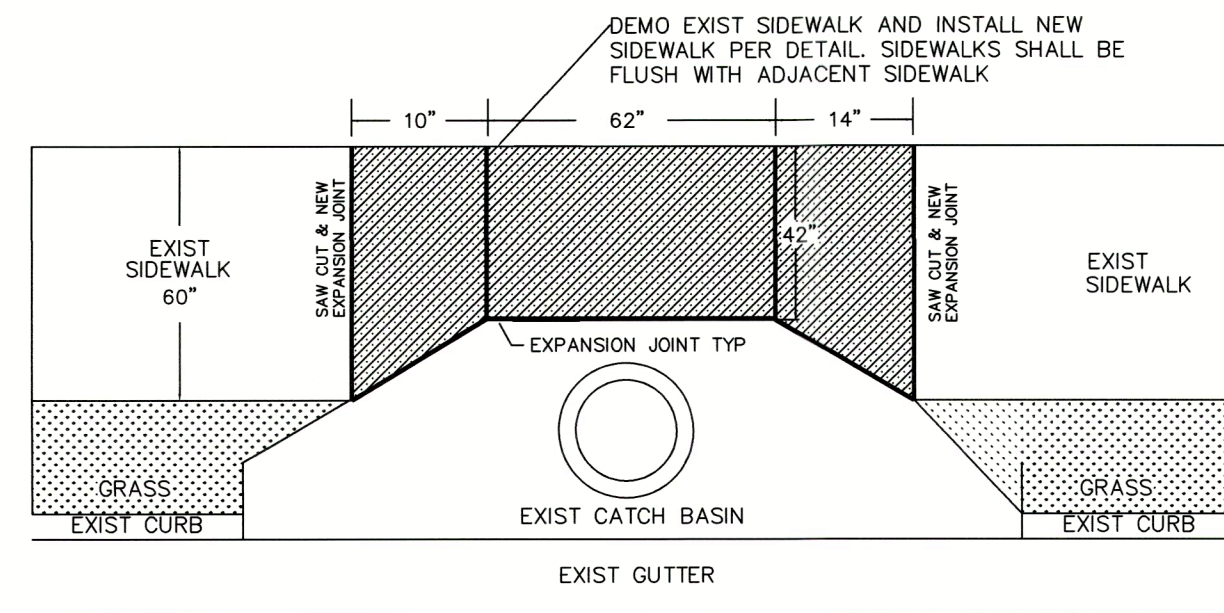

SIDEWALK REPAIR 901 DOGWOOD TRAIL  
 NTS

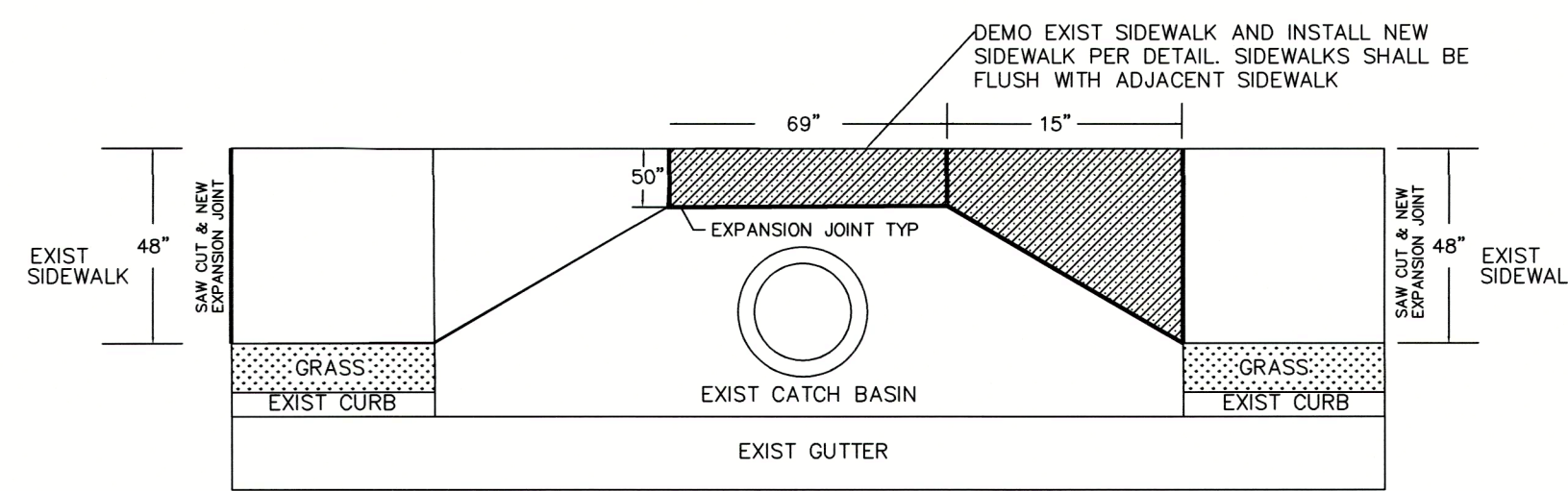

SIDEWALK REPAIR 411 WICKLOW  
 NTS

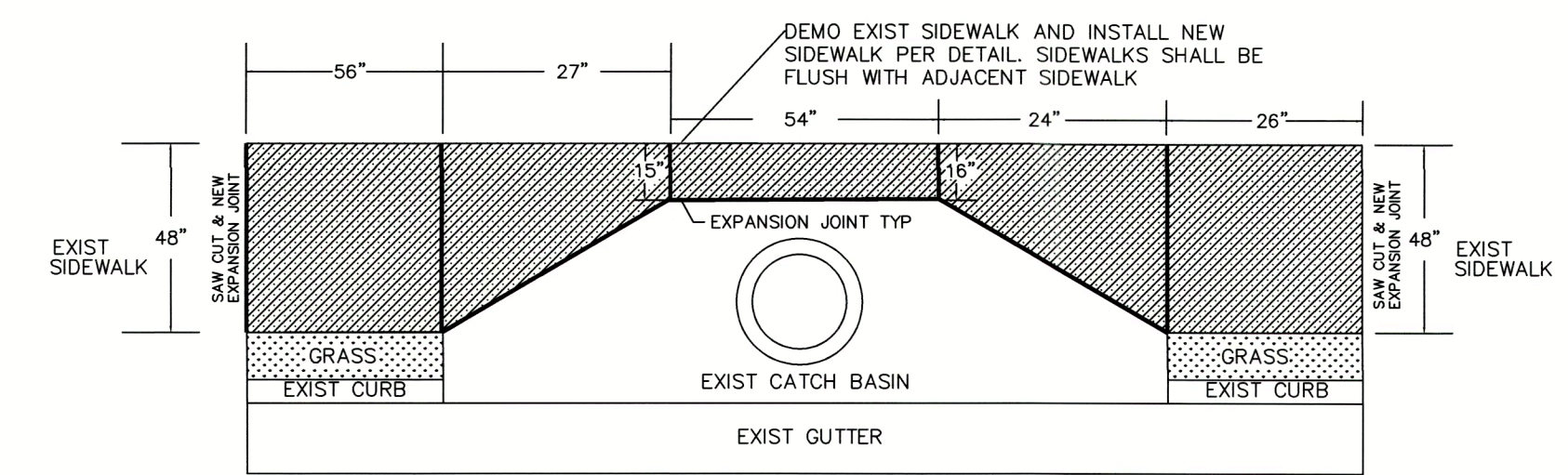

SIDEWALK REPAIR 120/130 IRISH LANE  
 NTS

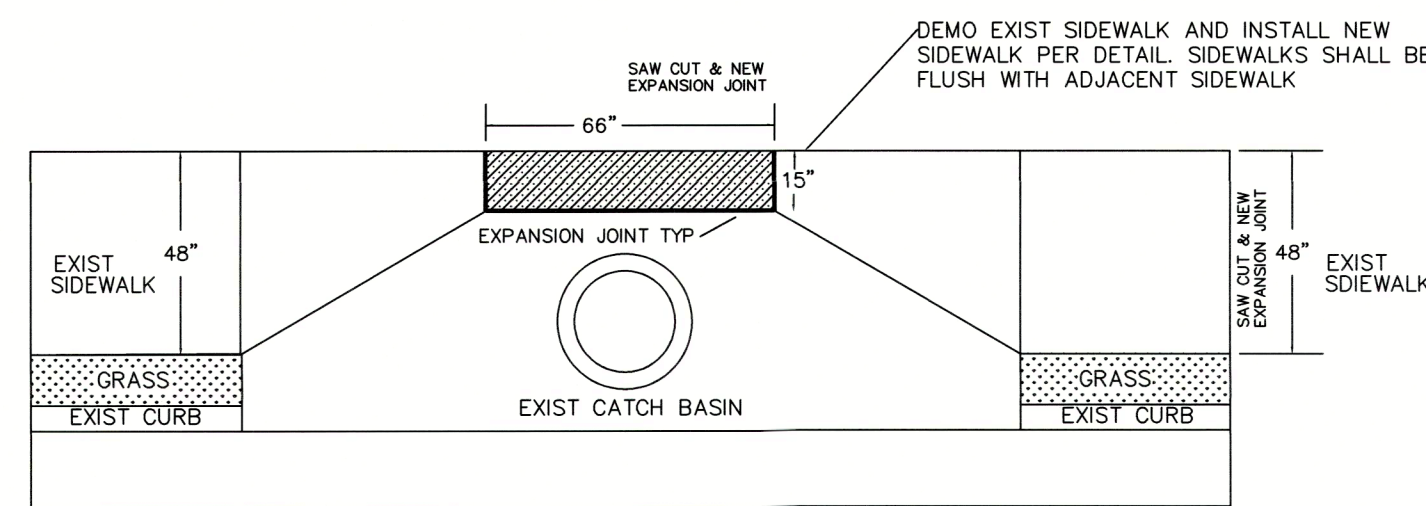

SIDEWALK REPAIR 430 PARK HAVEN LANE  
 NTS

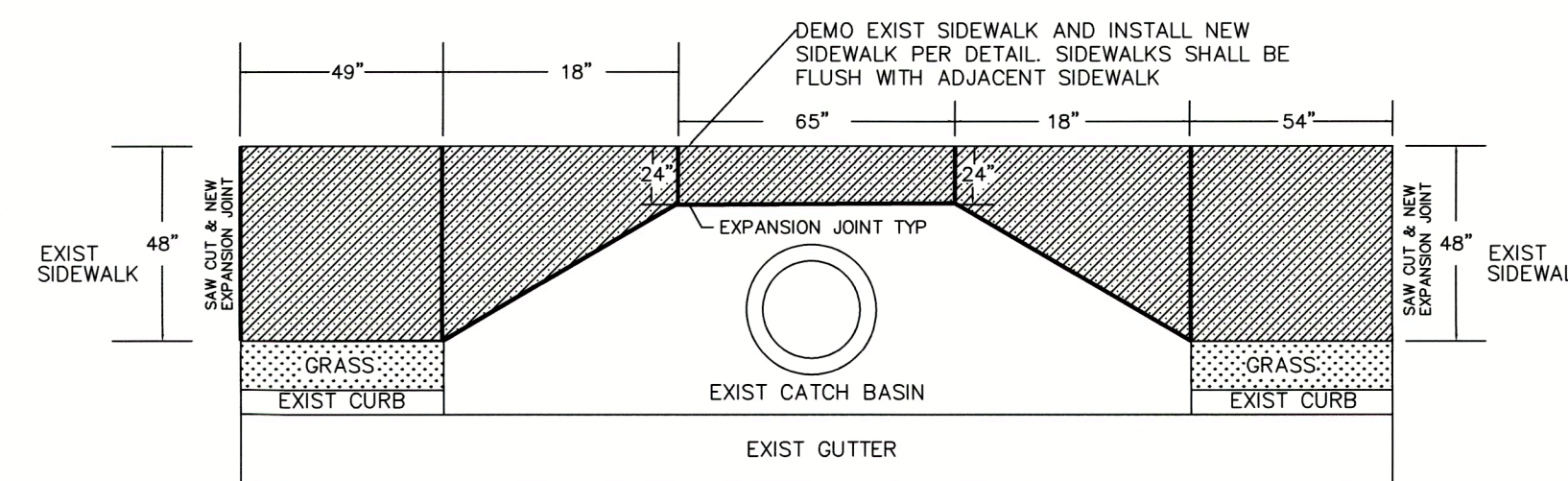

SIDEWALK REPAIR 140 CALVERTON  
 NTS

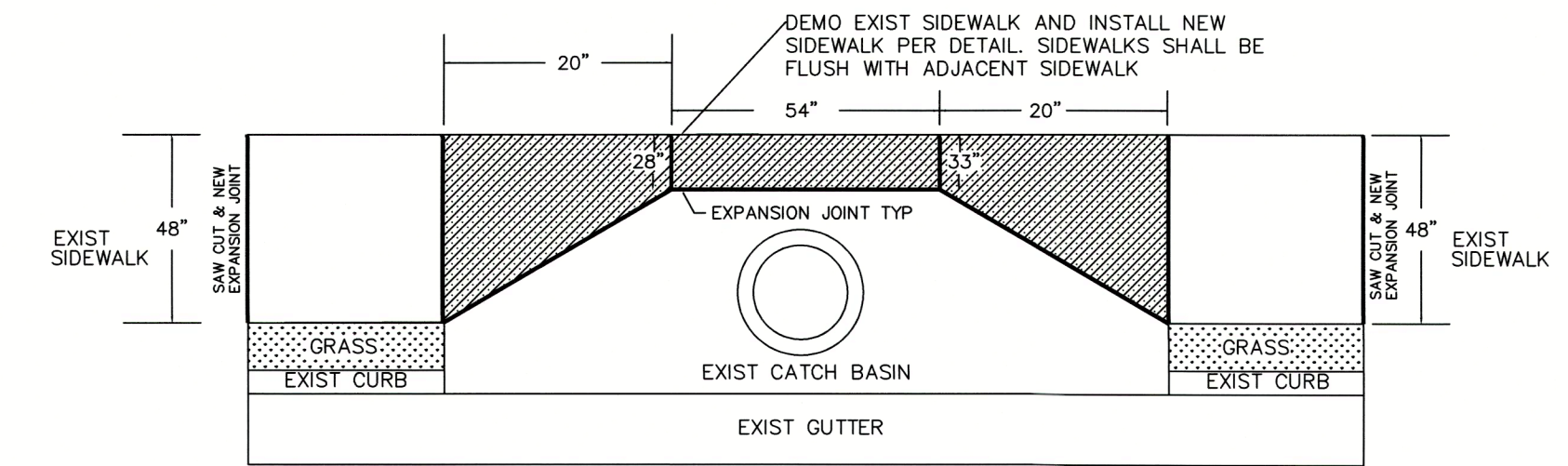

SIDEWALK REPAIR 175-185 CALVERTON LANE  
 NTS

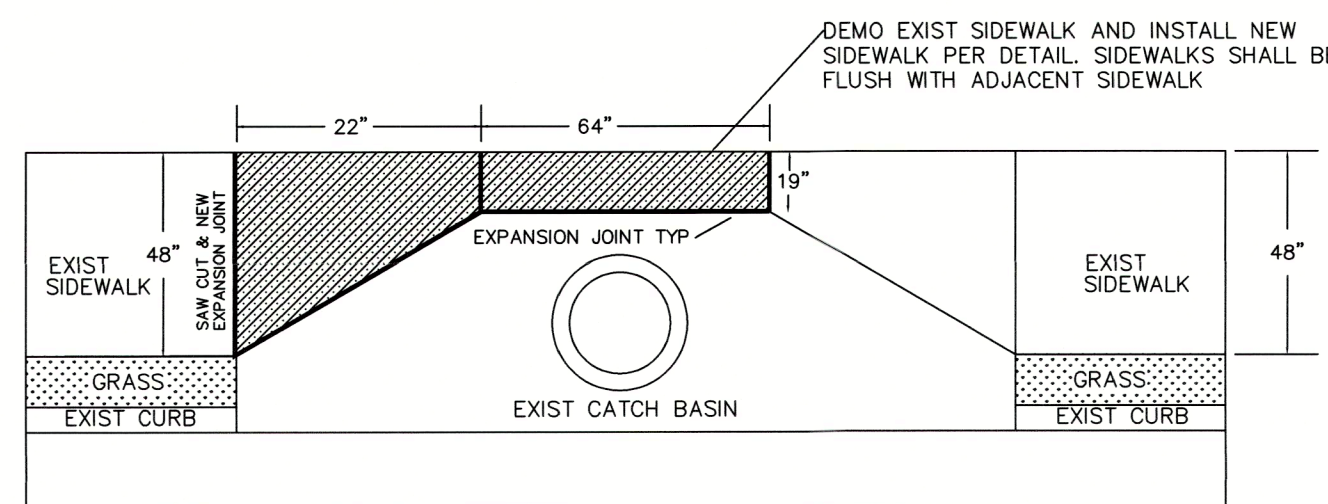

SIDEWALK REPAIR 115 HOLLY PARK LANE  
 NTS

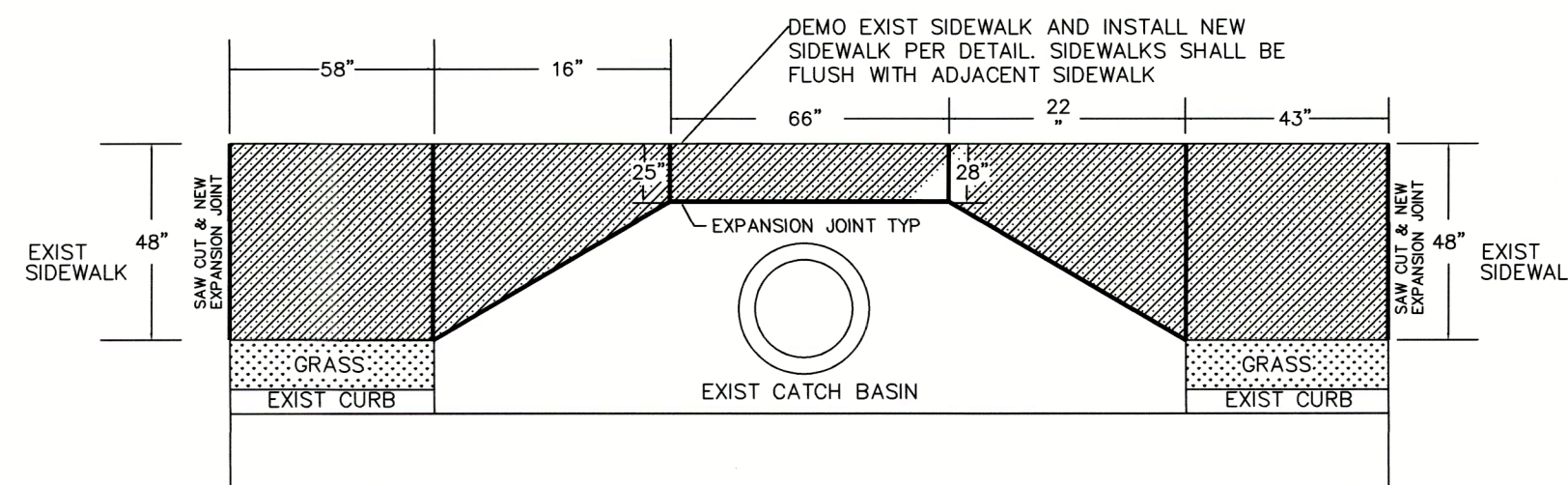

SIDEWALK REPAIR 200 CALVERTON LANE  
 NTS

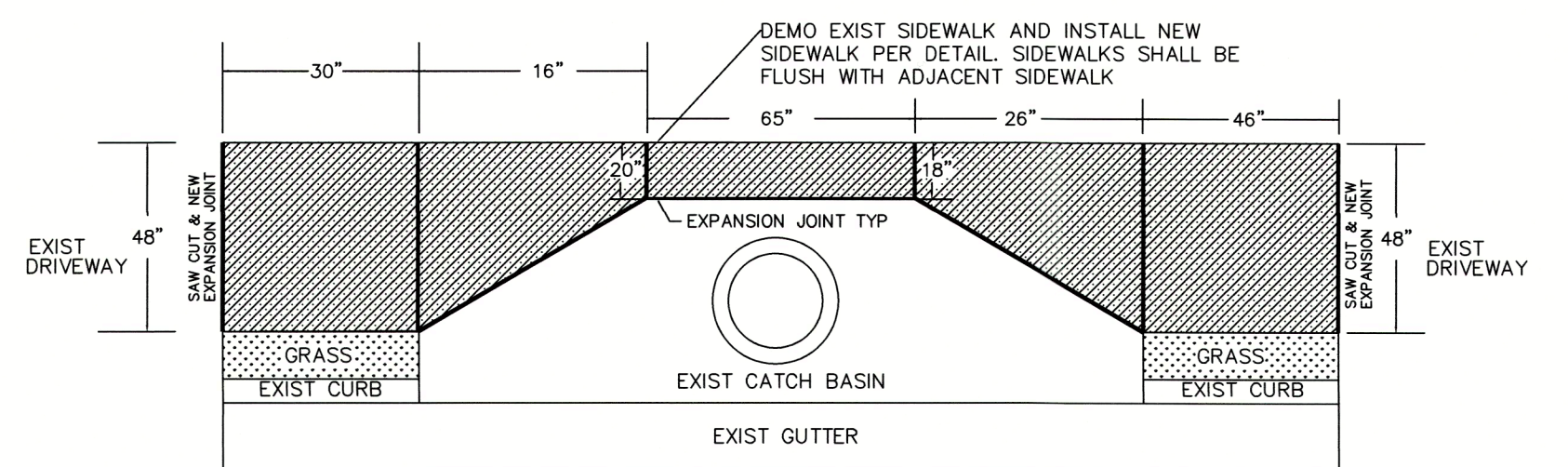

SIDEWALK REPAIR 145 CALVERTON LANE  
 NTS

2025 SIDEWALK REPAIRS

PW-2025-02

TOWN OF TYRONE

Project Name

RIVER CREST,  
 MILLBROOK, IRISH  
 VILLAGE, WINDSONG

Project No.

By

Date

Summary

Location

Site

SIDEWALK PLAN AND SCHEDULE

Sheet Title

Scale AS NOTED

Designed by SAL

Drawn by SAL

Sheet No. C101

Date DECEMBER 16, 2024

File name: 2025 SIDEWALK REPAIRS

ADDITIONAL SIDEWALK SECTIONS SCHEDULE				
(SEE SIDEWALK DETAILS AND NOTE SHEET C102)				
SECTION NUMBER	LOCATION	LINEAR FEET	SQUARE FEET	SPECIAL NOTES
A1	105 IRISH LANE	5'-0"	20.0	
A2	145 IRISH LANE	5'-2"	20.7	
A3	135-145 IRISH LANE	5'-0"	20.0	
A4	165 IRISH LANE	4'-0"	16.0	
A5	IRISH LANE ENTRANCE	3'-0"	12.0	NORTH SIDE
A6	IRISH LANE ENTRANCE	3'-0"	12.0	SOUTH SIDE
SECTION NUMBER	LOCATION	LINEAR FEET	SQUARE FEET	SPECIAL NOTES
RT	RIVERCREST SD 185 CALVERTON LANE	2'-10"	11.2	AT DRIVEWAY
SECTION NUMBER	LOCATION	LINEAR FEET	SQUARE FEET	SPECIAL NOTES
W1	WINDSONG SD 100 KENMARE COURT	5'-2"	25.8	
W2	100 KENMARE COURT	4'-10"	24.2	
W3	100 KENMARE COURT	5'-3"	26.3	
W4	100 KENMARE COURT	5'-2"	25.8	
W5	103 KENMARE COURT	6'-4"	31.7	
W6	111 KENMARE COURT	7'-9"	38.8	
W7	120 KENMARE COURT	5'-11"	29.6	
W8	104 KILKENNY	5'-5"	27.1	
W9	105/107 KILKENNY	6'-2"	25.8	
W10	105 KILKENNY	3'-0"	15.0	
W11	903 DOGWOOD TRAIL	6'-3"	25.0	
W12	905 DOGWOOD TRAIL	4'-8"	22.1	
W13	902 DOGWOOD	8'-0"	40.0	
W14	312 ROUNDSTONE ROCK	5'-0"	25.0	
W15	302 ROUNDSTONE ROCK	7'-0"	35.0	
W16	302 ROUNDSTONE ROCK	6'-8"	33.3	
W17	303 ROUNDSTONE ROCK	4'-7"	22.9	
W18	303 ROUNDSTONE ROCK	5'-6"	27.5	TRIANGLE SECTION
W19	592 MCDADE STREET	20'-4"	101.5	⊗ CORNER-ROUNDSTONE
W20	583 MCDADE STREET	6'-10"	34.2	
W21	583 MCDADE STREET	7'-8"	38.3	
W22	583 MCDADE STREET	13'-4"	53.3	
W23	583 MCDADE STREET	7'-3"	36.3	
W24	585 MCDADE STREET	2'-0"	10.0	NEAR TRANSFORMER
W25	597 MCDADE STREET	5'-4"	26.7	
W26	598 MCDADE STREET	4'-8"	23.3	
W27	598 MCDADE STREET	4'-6"	22.5	
W28	405 WICKLOW STREET	4'-9"	23.8	
W29	405 WICKLOW STREET	4'-8"	22.1	
W30	101/103 BERESFORD	5'-8"	28.3	
W31	106 BERESFORD	6'-6"	32.5	
W32	106 BERESFORD	5'-3"	26.3	
W33	113 BERESFORD	16'-0"	80.0	
W34	202 DUNQUIN ROCK	11'-9"	58.3	
W35	202 DUNQUIN ROCK	5'-0"	25.0	
W36	204 DUNQUIN ROCK	4'-11"	24.6	
W37	203 DUNQUIN ROCK	6'-1"	30.4	
W38	205 DUNQUIN ROCK	10'-0"	50.0	
W39	206 DUNQUIN ROCK	8'-6"	42.5	
W40	206 DUNQUIN ROCK	4'-10"	24.2	
W41	205 DUNQUIN ROCK	4'-10"	10.3	TRIANGULAR SHAPE
W42	105/107 OCONNEL	3'-0"	12.0	
SECTION NUMBER	LOCATION	LINEAR FEET	SQUARE FEET	SPECIAL NOTES
C1	ASHPARK SD (BROOKS) 105 CREGGANHILL			
C2	111 CREGGANHILL		26.4	TRIANGLE SHAPE
SECTION NUMBER	LOCATION	LINEAR FEET	SQUARE FEET	SPECIAL NOTES
M1	MILLBROOK VILLAGE SD 240 MILLBROOK DRIVE	7'-5"	29.6	
M2	250 MILLBROOK DRIVE	6'-0"	24.0	
M3	420 MILLBROOK DRIVE	3'-4"	13.3	
M4	520 MILLBROOK DRIVE	4'-0"	16.0	
M5	640 MILLBROOK DRIVE	2'-8"	5.6	
M6	650 MILLBROOK DRIVE	4'-6"	18.0	
M7	650 MILLBROOK DRIVE	2'-10"	11.2	
M8	680 MILLBROOK DRIVE	5'-10"	20.8	
M9	680 MILLBROOK DRIVE	5'-0"	20.0	
M10	690 MILLBROOK DRIVE	4'-7"	18.3	
M11	690 MILLBROOK DRIVE	5'-6"	22.0	
M12	695 MILLBROOK DRIVE	9'-11"	39.7	STOP SIGN
M13	695 MILLBROOK DRIVE	9'-1"	36.3	NEAR CATCH BASIN
M14	695 MILLBROOK DRIVE	5'-7"	22.3	NEAR CATCH BASIN
M15	695 MILLBROOK DRIVE	5'-2"	20.6	
M16	695 MILLBROOK DRIVE	4'-10"	19.3	
M17	105 DAISY HILL	6'-10"	27.3	
SECTION NUMBER	LOCATION	LINEAR FEET	SQUARE FEET	SPECIAL NOTES
V1	VETERAN'S PARK VETERAN'S PARK	3'-8"	18.3	
V2	VETERAN'S PARK	4'-10"	19.2	
V3	VETERAN'S PARK	7'-8"	38.3	
V4	VETERAN'S PARK	7'-8"	38.3	
V5	VETERAN'S PARK	4'-0"	20.0	
V6	VETERAN'S PARK	7'-8"	38.3	
V7	VETERAN'S PARK	11'-0"	55.0	
V8	VETERAN'S PARK	7'-7"	37.9	
V9	VETERAN'S PARK	7'-0"	35.0	
V10	VETERAN'S PARK	12'-9"	63.8	
V11	VETERAN'S PARK	4'-10"	19.2	

BEFORE DIGGING IN  
GEORGIA  
CALL 811

TOWN OF TYRONE  
950 SENOIA ROAD  
TYRONE, GA 30290  
770-487-4038



2025 SIDEWALK REPAIRS  
PW-2025-02  
TOWN OF TYRONE

Project Name  
Project No.  
Location

RIVER CREST, ASPARK  
MILLBROOK, IRISH  
VILLAGE, WINDSONG

SIDEWALK  
DETAILS &  
SCHEDULE

Sheet Title  
Scale AS NOTED  
Designed by SAL  
Drawn by SAL  
C102  
Sheet No.  
Date DECEMBER 16, 2024  
Filename: 2025 SIDEWALK REPAIRS

- PROJECT GENERAL NOTES:
- 1) SIDEWALK WILL BE MARKED IN THE FIELD AT PRECON WITH CONTRACTOR AND THE TOWN OF TYRONE (OWNER).
  - 2) CONTRACTOR IS RESPONSIBLE FOR UTILITY LOCATES AND MARKING BEFORE CONSTRUCTION. ANY DAMAGE TO UTILITIES WILL BE REPAIRED TO THE UTILITY COMPANY'S ACCEPTANCE AND PAID BY THE CONTRACTOR. ALL REPAIRS WILL BE AT NO COST TO THE OWNER.
  - 3) INSPECTION ARE REQUIRED PRIOR TO CONCRETE POUR. CONTRACTOR WILL CONTACT OWNER 48 HOURS PRIOR TO POUR FOR INSPECTION. OWNER WILL PAY FOR ONE INSPECTION FOR EACH POUR AND ANY RE-INSPECTIONS OR DELAYS WILL BE AT THE COST OF THE CONTRACTOR.
  - 4) CONTRACTOR IS RESPONSIBLE FOR ALL TRAFFIC CONTROL. TRAFFIC CONTROL SHALL MEET MUTCD AND GDOT REQUIREMENTS.
  - 5) CONTRACTOR SHALL PROVIDE WARNING SIGNAGE AND BARRIERS AROUND OPEN EXCAVATIONS AND WORK AREAS.
  - 6) PLANS ARE A GENERAL REPRESENTATION OF LOCATION AND DIMENSIONS. CONTRACTOR IS REQUIRED TO PERFORM A SITE VISIT PRIOR TO BID TO FIELD VERIFY ALL ONSITE CONDITIONS AND MEASUREMENTS. NO ADJUSTMENTS WILL BE MADE IN COST FOR ANY ITEM THAT COULD/SHOULD HAVE BEEN IDENTIFIED DURING A SITE VISIT.
  - 7) WORK HOURS SHALL BE 8AM TO 6PM. WORK BEYOND THESE HOURS MUST BE APPROVED IN WRITING BY THE OWNER PRIOR TO THE WORK BEING PERFORMED.
  - 8) CONTRACTOR SHALL BE RESPONSIBLE FOR ALL WORK SAFETY AND COMPLIANCE WITH OSHA REGULATIONS. THE CONTRACTOR SHALL NOT PLAY MUSIC OR ALLOW SMOKING ON THE JOB SITE.
  - 9) CONTRACTOR SHALL BE RESPONSIBLE FOR SITE SECURITY. LOCATION FOR OVERNIGHT PARKING OF EQUIPMENT AND VEHICLES MUST BE APPROVED BY THE OWNER.
  - 10) COLLECTION OF TRASH/DEBRIS SHALL BE AT THE END OF EACH WORK DAY. ALL TRASH/DEBRIS SHALL BE DISPOSED OF LEGALLY OFFSITE.
  - 11) CONTRACTOR SHALL INSTALL AND REMOVE EROSION CONTROL MEASURES AS NEEDED AT EACH LOCATION. THIS INCLUDES PROVIDING A CONCRETE WASHOUT AREA/DUMPSTER.
  - 12) CONTRACTOR SHALL REPLACE ALL GRASS AREAS DISTURBED WITH SOD THAT MATCHES THE SPECIES OF THE EXISTING SOD. ANY OTHER LANDSCAPING SHALL BE REPLACED TO MATCH THE PRE-CONSTRUCTION CONDITIONS. (THIS INCLUDES, BUT IS NOT LIMITED TO, MULCH, PINE STRAW, BUSHES, AND IRRIGATION SYSTEM PARTS).
  - 13) CONTRACTOR IS RESPONSIBLE FOR REMOVAL AND DISPOSAL OF EXISTING CONCRETE SIDEWALK AND PROTECTING EXISTING CONCRETE TO REMAIN. ALL CUTS SHALL BE SAW CUT. ALL CUTS SHALL BE CONSIDERED AN EXPANSION JOINT AND SHALL HAVE JOINT FILLER PER EXPANSION JOINT DETAIL.
  - 14) NEW SIDEWALK TOOLING AND FINISH SHALL MATCH EXISTING SIDEWALK.
  - 15) ALL CONCRETE SIDEWALKS SHALL BE 3000 PSI FIBER REINFORCED CONCRETE WITH 1.5 POUNDS OF FIBER PER CUBIC YARD ADDED AT THE CONCRETE PLANT. CONTRACTOR SHALL PROVIDE LOAD TICKETS FROM THE PLANT STATING MIX PSI AND FIBER CONTENT TO THE OWNER/INSPECTOR.

THIS DETAIL APPLIES TO ALL SUBDIVISION SIDEWALKS

